



Tonight's Agenda

- 6:00 pm – Open House
- 6:30 pm – Presentation
 - **Introduction**
 - Ron Endlich, North Link Deputy Project Director
 - **Roosevelt Station Construction**
 - Kristin Hoffman, Station Project Manager
 - **Next Steps**
 - **Questions and Answers**
- 7:45 pm – Return to Open House
- 8:30 pm – Close

Roosevelt Station Construction Open House

November 3, 2011



 **SOUNDTRANSIT**
RIDE THE WAVE

Link Light Rail System

- 16 miles of light rail with 13 stations currently in service
- University Link under construction; opens 2016
- ST2 Plan funded extensions to Overlake, Federal Way, and Lynnwood
- 54 mile system



North Link

(University District to Northgate)

- 4.3-mile light rail extension
- Stations at Brooklyn, Roosevelt, and Northgate
- Completion: 2021
- 62,000 daily boardings added to system by 2030



Roosevelt Station

Key Features

- Station platform 70'-90' underground
- Elevators, escalators and stairs at both entrances
- Bicycle parking
- Connections to buses on NE 65th St, 12th Ave NE and Roosevelt Way NE
- 8,000 daily boardings (2030)



Transit Oriented Development (TOD)



STart

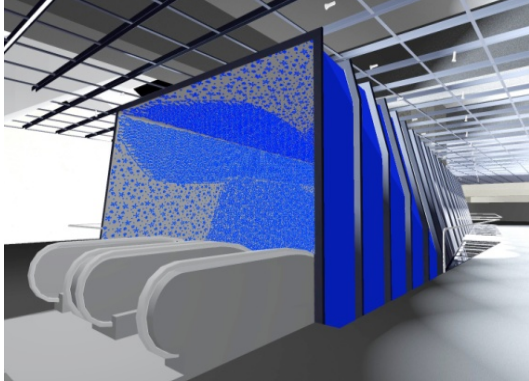

Roosevelt Station Schedule

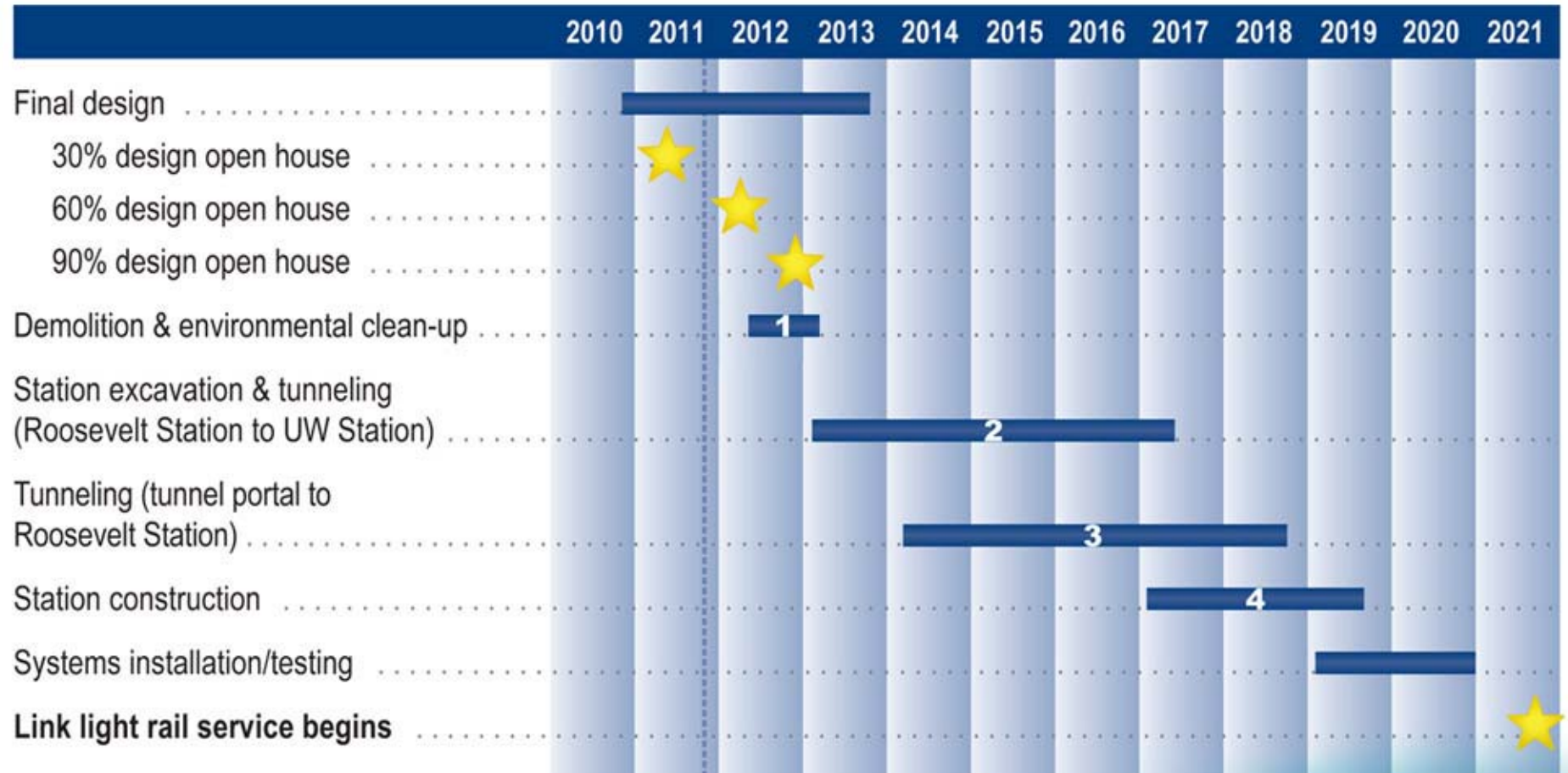

ST Standard Construction Procedures



- Standard provisions written into contracts
- Promote the local business district
- 24-hour construction hotline (888-298-2395)

Pre-Demolition Activity Salvage



- Townhouses – no buyer(s) found; buildings salvaged prior to removal
- Building salvage – light fixtures, doors, windows, wood beams, etc. salvaged prior to building removal
- Plant salvage event – will occur in early 2012 and be open to the public
- Standard Radio – façade deconstructed



1. Site Demolition Contract

Mid 2012 – Early 2013

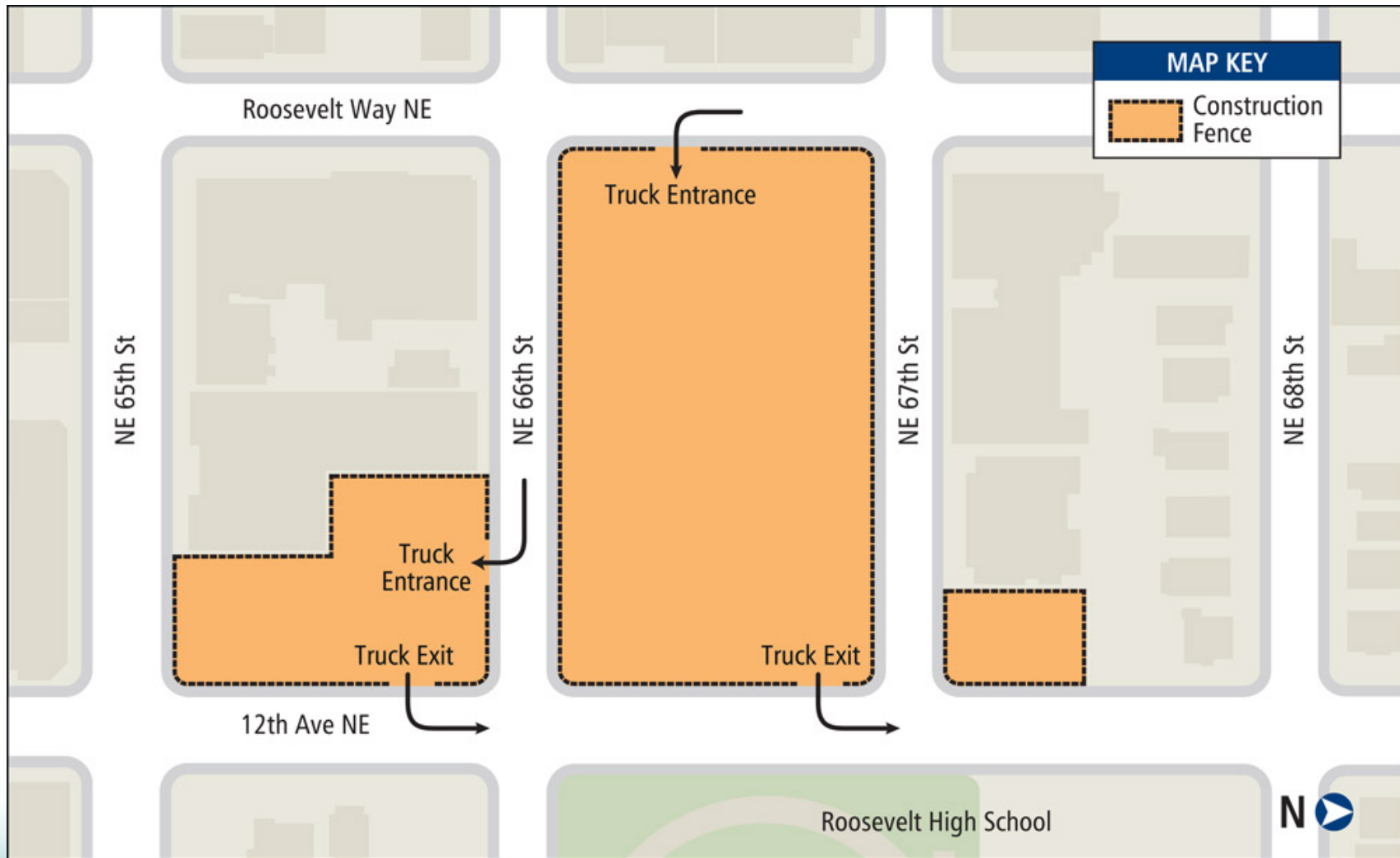

1. Demolition Phase Tree Removal



- Townhouses – trees and shrubs to be removed
- Businesses along 12th Ave NE – trees and shrubs to be removed
- QFC – majority of trees and shrubs to be removed

1. Dust Control



- Watering during demo
- Covered loads
- Street sweeping
- Wheel washes



2. Excavation and Tunneling Contract

2013 - 2017

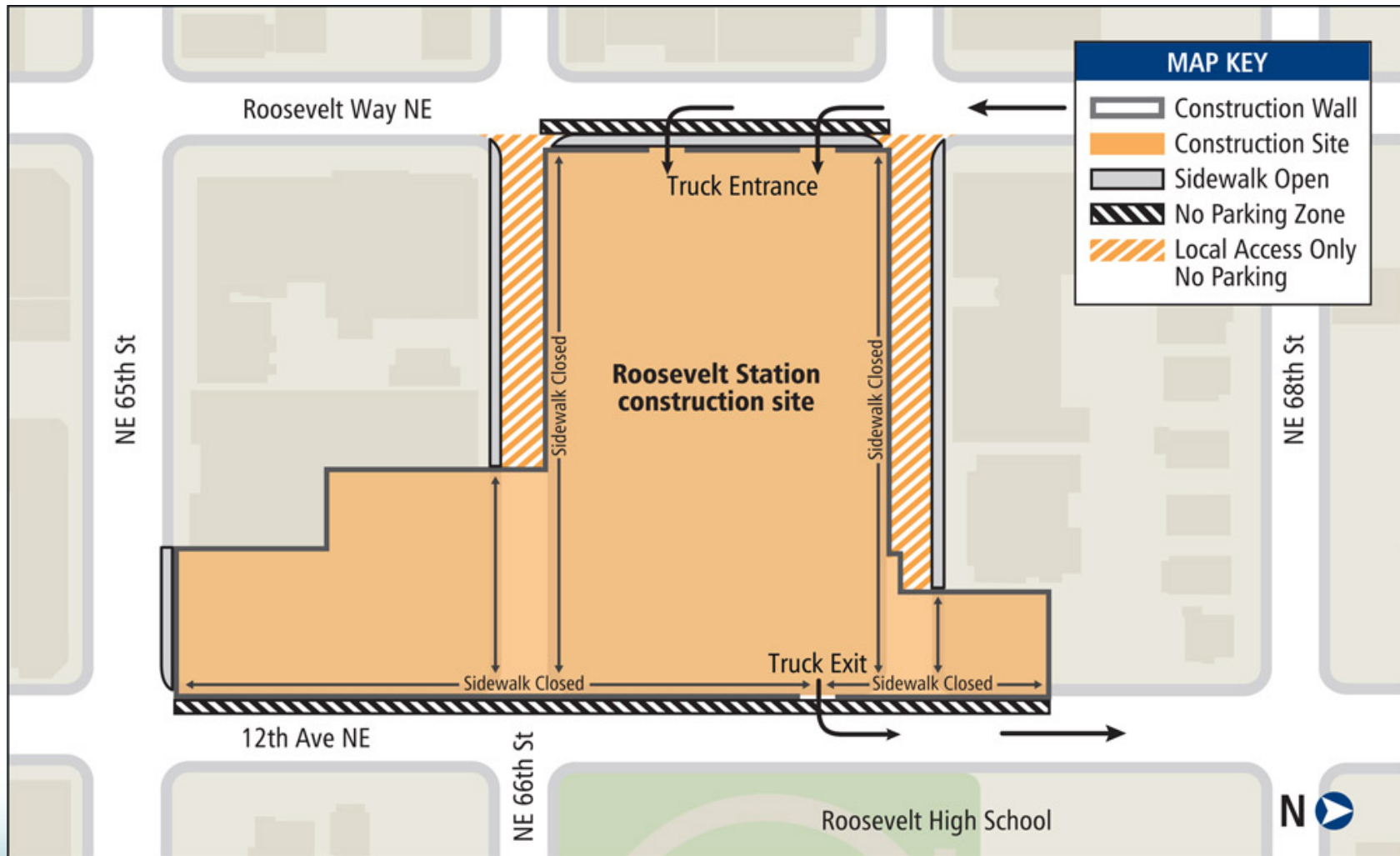

2. Utility Relocation



- NE 66th Street
- NE 67th Street
- 12th Avenue NE
- Roosevelt Way NE



2. Scarlet Oak Trees



- Trees located in NE 67th Street right-of-way
- ST explored options to relocate trees but no feasible solution found
- ST exploring options for tree salvage and reuse

2. Typical Construction Activities



2. Noise Mitigation



- Solid plywood construction screening wall (8'-16' tall)
- Stationary equipment (compressors, generators) enclosed in noise reducing material
- Trucks – no beeping alarms at night
- Monitoring

2. Noise Variance



- ST will seek Major Public Project Construction Noise Variance from City of Seattle
- Noise variance establishes noise limits for contractor work between 10pm - 7am weekdays, 10pm - 9am weekends, holidays
- Daytime construction activities will comply with City's construction noise limits
- More noise information at next construction open house

2. Exterior Construction Wall Lighting



- Construction lighting
 - inside construction walls
 - fixtures shrouded, directing light downward
- Security lighting
 - exterior lighting on construction walls
 - Balance illumination for security while minimizing stray lighting

2. Truck Route (from north)

- Trucks enter site southbound from Roosevelt Way NE
- Trucks leave site northbound on 12th Avenue NE



2. Truck Route (from south)

- Trucks enter site southbound from Roosevelt Way NE
- Trucks leave site northbound on 12th Avenue NE



2. Tunneling and Excavation Animation

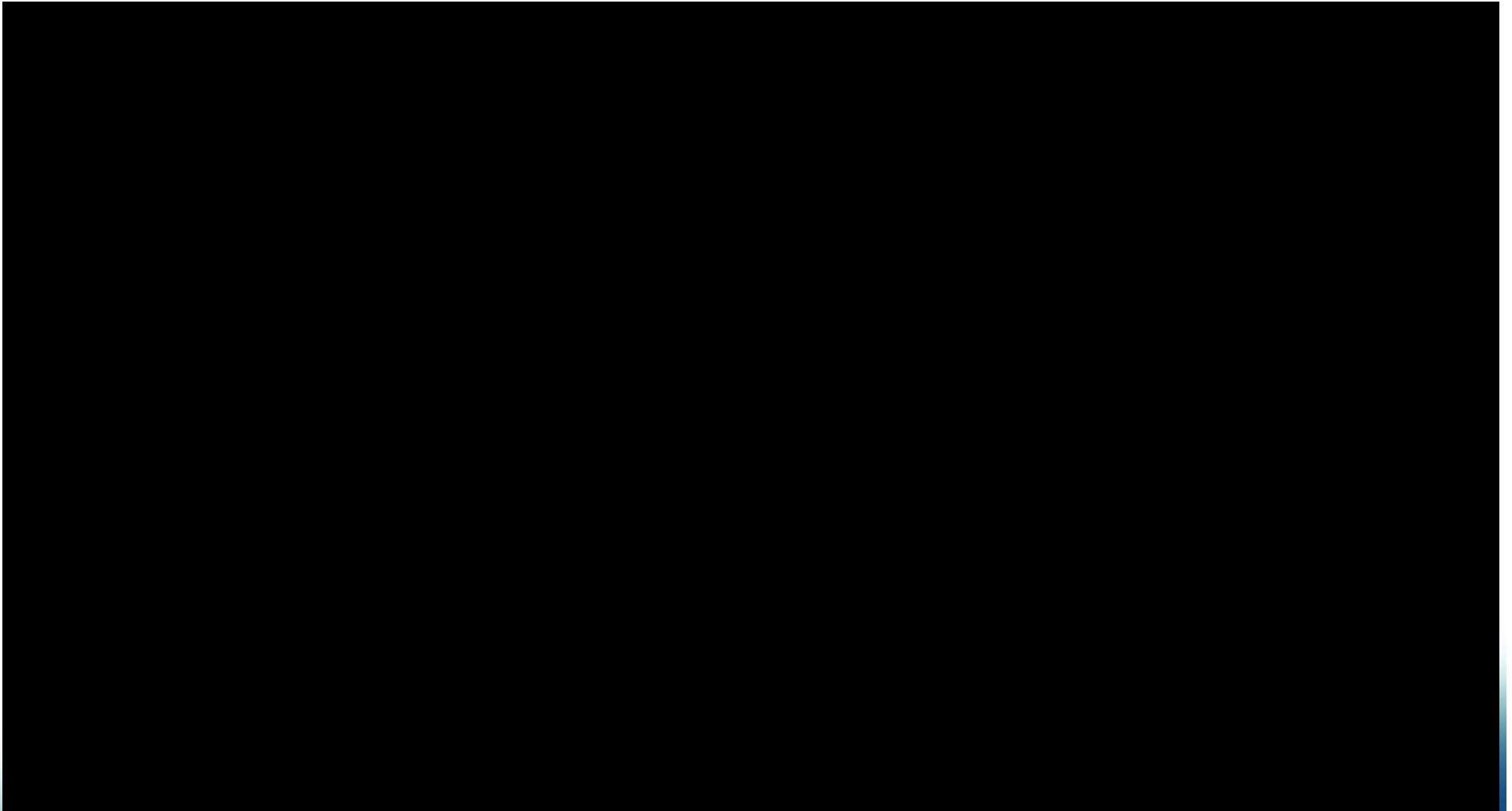

4. Station Construction Contract

2017-2019

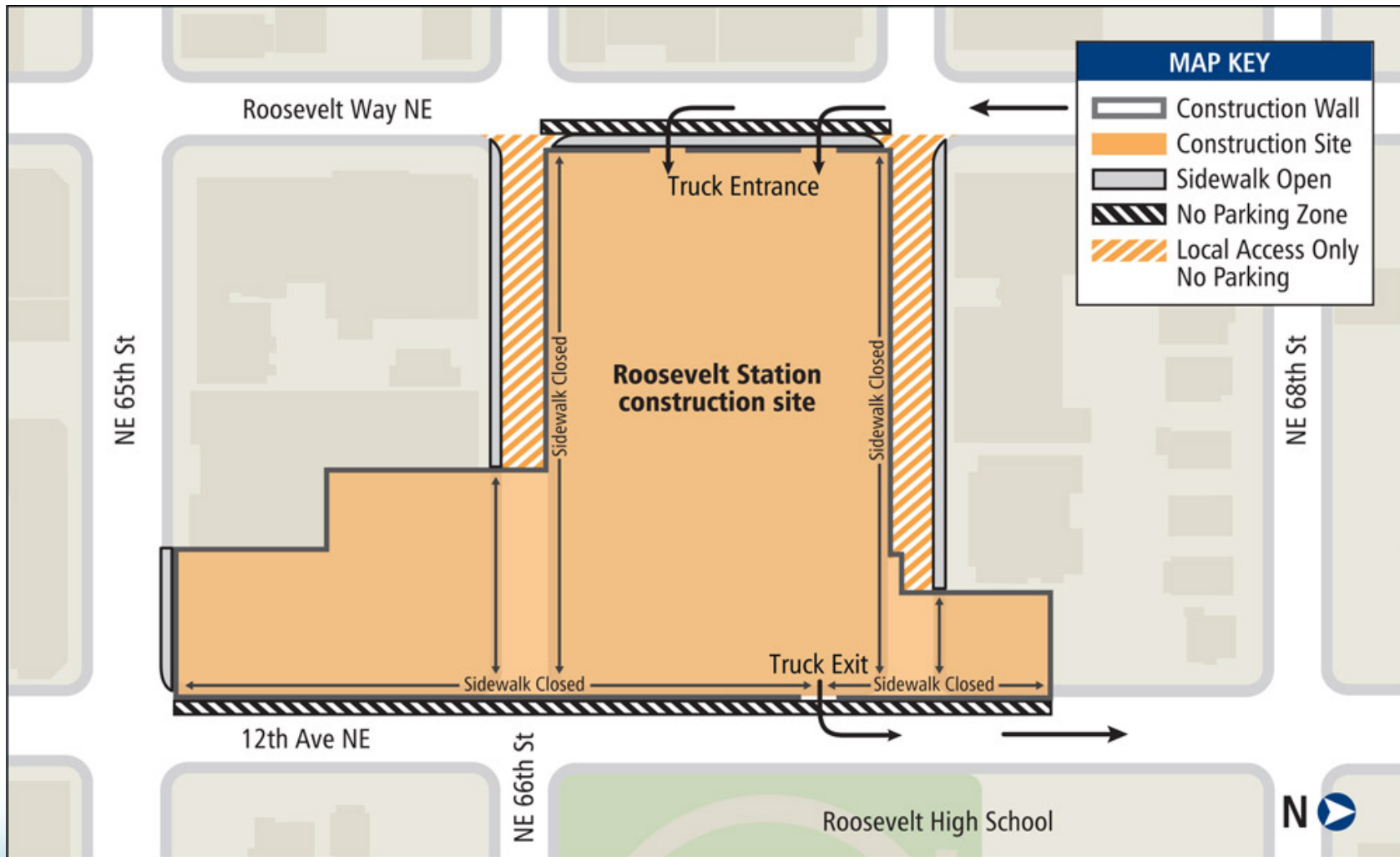

Next Steps



- Meet the Artists – December 2011/January 2012
- Plant salvage event – Early 2012
- Roosevelt construction open house – Winter 2012
- Station 60% design open house – Spring 2012
- Station naming

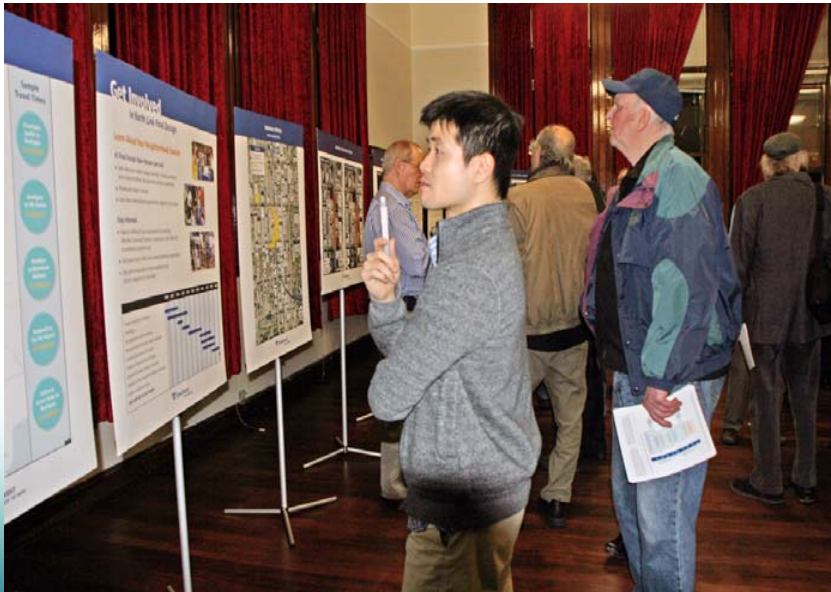

Questions?



Get Involved and Stay Informed



- Attend Final Design Open Houses
 - Learn more about your neighborhood station's design including bike facilities, pedestrian and bike connections and public art
- Sign Up to Receive Email Updates
 - www.soundtransit.org/subscribe
- Sound Transit Website
 - www.soundtransit.org/northlink
- Contact Ellen Blair:
 - 206.398.5043
 - northlink@soundtransit.org